



EYE-BALL JET NOZZLE - BJN MODEL

CONSTRUCTION

- BJN is particularly designed for long-throw cooling or heating applications.
- 360° Adjustable air direction within $\pm 30^\circ$ degrees angle.
- Made of Aluminum construction.
- Powder coated finish to RAL 9010/9016.
- Fixing by means of screws hidden behind front frame.
- BJNP model combines more than one nozzle within rectangular panel; as a set of 2, 3 or 4 nozzles per panel.



DIMENSIONS

Size	Dimensions in mm			
	A	B	C	D
125	60	172	125	102
160	76	199	151	128
200	106	264	201	142
250	127	309	249	199
315	180	377	315	217
400	220	468	399	224

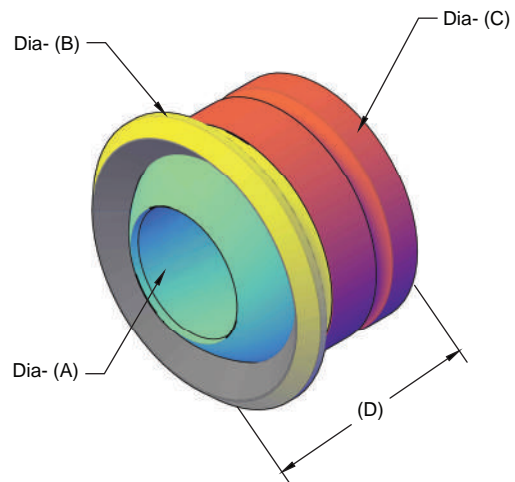

INSTALLATION

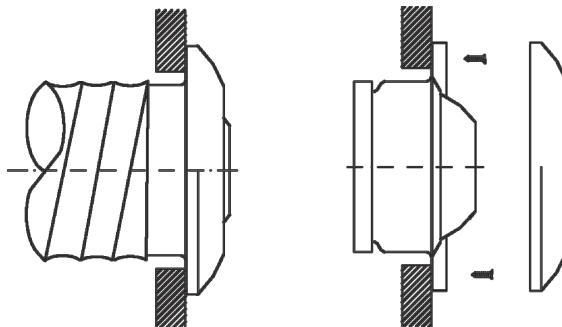



EYE-BALL JET NOZZLE - BJN MODEL

PERFORMANCE DATA

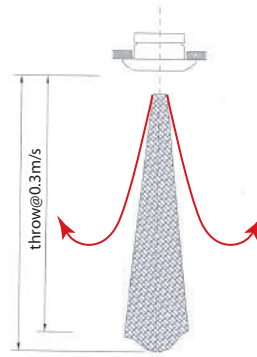
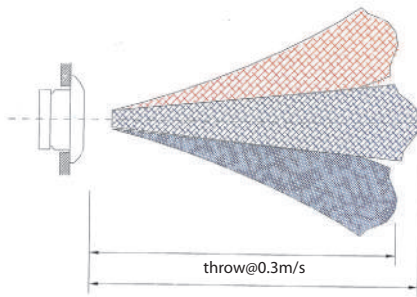
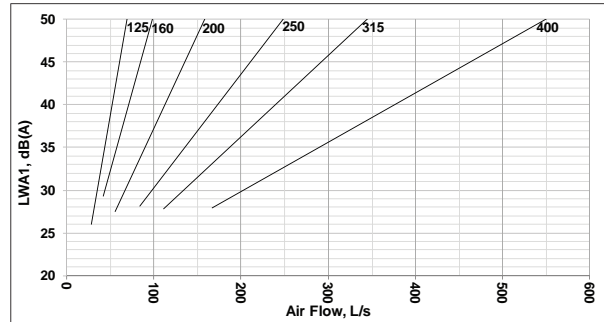
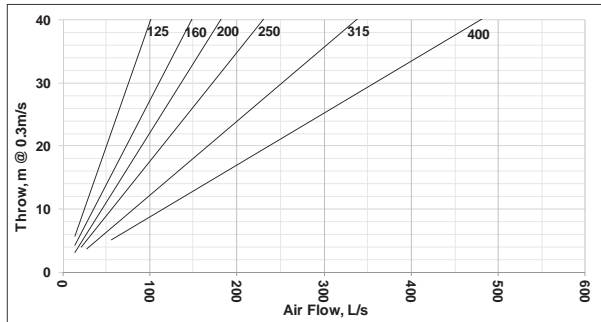
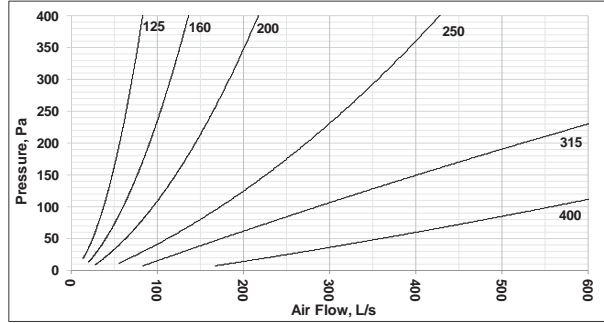
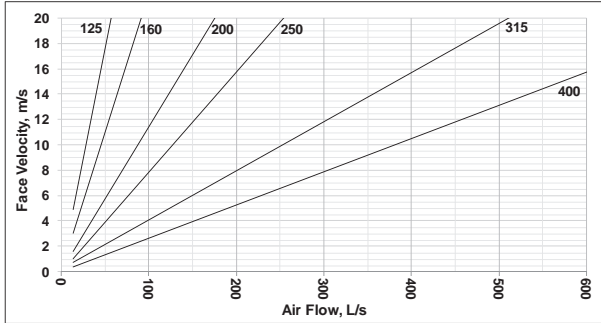

Ordering Key:

B	J	N	P	3	2	0	0
EYE-BALL JET NOZZLE							
-: INDIVIDUAL NOZZLE _ STANDARD							
P: NOZZLES COMBINED ON A PANEL							
NO. OF NOZZLES (1-4) COMBINED ON A PANEL FOR BJNP MODEL ONLY							
SIZE: 125, 160, 200, 250, 315 OR 400							

