



C CA MD RANGE

In-line cabinet centrifugal fans in metal



PRODUCT SPECIFICATIONS

Suitable for residential, commercial and industrial applications: kitchens, bathrooms, offices, laboratories, factories, shops, laundromats, restaurants, bars, theatres, ballrooms, etc.



FANS & MOTOR

- **8 models:** from 100 diameter to 315.
- Stripped and phosphated steel structure, painted with polyester powder which is particularly resistant to the aggressive action of atmospheric agents.
- Two speeds.
- Backward curved centrifugal impellers.
- High efficient ball bearing motors.
- Low noise emissions.
- Low specific consumption
- Direction fans optimised to reduce turbulence inside the appliance.
- Wide range of continuous operation temperatures between -25°C and +50°C.
- Insulation class: II

CABINET CASING

- Compact and space saving design.
- Housings are weather resistant, fabricated from pregalvanized sheet steel.
- Stainless steel and aluminum casings are available as optional.
- Epoxy or powder coating and acoustical insulation on inner side of housing.
- Factory installed Back draft dampers as standard.
- Protection rating: IP55

LONG LIFE 30.000 h



TECHNICAL DATA

Models	Code	W min/max	A min/max	RPM min/max	Max Airflow		Max Pressure		Lp dB(A)* min/max	Max °C
					m³/h min/max	l/s min/max	mmH ₂ O min/max	Pa min/max		
C CA 100 MD	16150	60 - 85	0.30 - 0.40	1730 - 2450	220 - 340	61 - 94	30 - 39	294 - 383	32.2 - 43.2 (*)	50
C CA 125 MD	16151	60 - 85	0.30 - 0.40	1580 - 2380	280 - 450	78 - 125	27 - 37	265 - 363	30.8 - 45.9 (*)	
C CA 150 QMD	16152	60 - 85	0.30 - 0.40	1430 - 2350	300 - 500	83 - 139	21 - 35	206 - 343	34.7 - 48.1 (*)	
C CA 150 MD	16153	110 - 155	0.50 - 0.70	1815 - 2080	570 - 770	188 - 214	44 - 54	432 - 530	40.7 - 48.0	
C CA 160 MD	16154	110 - 155	0.55 - 0.70	1654 - 2080	640 - 840	178 - 228	41 - 50	402 - 491	40.7 - 47.4	
C CA 200 MD	16155	110 - 155	0.55 - 0.70	1700 - 2100	820 - 1050	228 - 292	37 - 48	363 - 471	43.8 - 49.6	
C CA 250 MD	16156	115 - 200	0.55 - 0.90	1800 - 2420	950 - 1300	264 - 361	42 - 56	412 - 549	46.7 - 55.9	
C CA 315 MD	16157	190 - 280	0.85 - 1.25	1940 - 2500	1350 - 1800	375 - 500	52 - 72	510 - 706	52.4 - 57.7	

Available only for the Extra EU market**

* Sound pressure level measured at 3 m in free field conditions with long-cased appliance in delivery mode in accordance with standard EN ISO 3741.

** Sound pressure level measured at 3 m in free field conditions with long-cased appliance in delivery mode in accordance with standard EN ISO 9614.

Electrical supply: 230 V ~ 50 Hz.

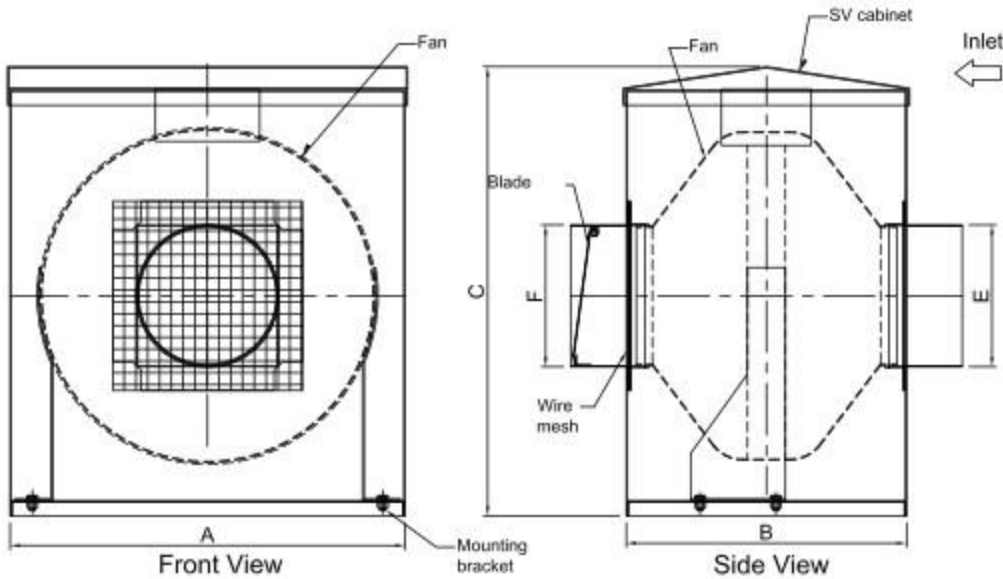

Models	A	B	C	E	F
CA 100MD	320	260	350	150X150	150X150
CA 125MD	320	260	350	150X150	150X150
CA 150QMD	320	260	350	150X150	150X150
CA 150MD	417	296	474	150X150	150X150
CA 160MD	450	300	469	160X160	160X160
CA 200MD	450	300	469	200X200	200X200
CA 250MD	450	300	469	250X250	250X250
CA 315MD	540	330	512	315X315	315X315

Galvanised sheet-metal brackets (for model Ø 100-125-150)

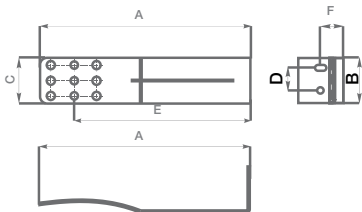

Models	A	B	C	D	E	F
Brackets	186	40	40	20	156	10

Galvanised sheet-metal brackets (for model Ø 200-250-315)

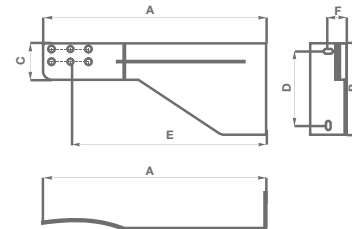

Models	A	B	C	D	E	F
Brackets	245	100	40	80	215	10

SOUND LEVELS

Models	Code	Speed	125 Hz	250 Hz	500 Hz	1K Hz	2K Hz	4K Hz	8K Hz
C CA 100 MD	16150	min	49.4	42	51.7	49.3	46.4	42.8	38.7
		max	58.2	53.3	60.7	59.8	56.5	54.1	46.3
C CA 125 MD	16151	min	45	51.7	51	45.9	42.1	35.1	n.a.
		max	55.4	63.4	64.5	61.6	58.7	55.2	48.4
C CA 150 QMD	16152	min	45.2	57.6	53.7	48.9	48.9	39.7	26.3
		max	55.9	68.4	66.1	62.6	62.6	56.9	48.9
C CA 150 MD	16153	min	56	65.4	59.7	53.3	50	42.6	32.8
		max	62.2	71.1	67.3	61.6	59.2	51.9	44.6
C CA 160 MD	16154	min	58.6	64.9	59.8	53	53	41.5	32.2
		max	62.1	70.4	66.5	60.9	60.9	50.4	43.1
C CA 200 MD	16155	min	58	68.3	61.5	55.4	54.2	45.7	38
		max	61.5	70.3	69.7	63.2	60.8	54.5	47.4
C CA 250 MD	16156	min	60.2	69.6	65.1	60.9	58.5	51.5	44.7
		max	68.8	71.2	77.9	69.4	65.8	60.9	55.6
C CA 315 MD	16157	min	70.8	71.8	74	64.7	62.8	60.5	57.7
		max	74.3	72.4	77.6	71.6	70.3	67.1	66

Frequency bands in octaves and sound output. The measurements of the sound power have been carried out according to international standards EN ISO-3741.



C CA MD
RANGE

PERFORMANCE CURVES

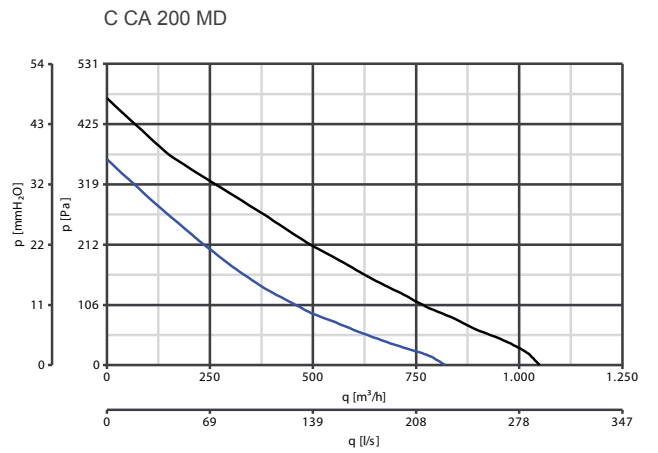
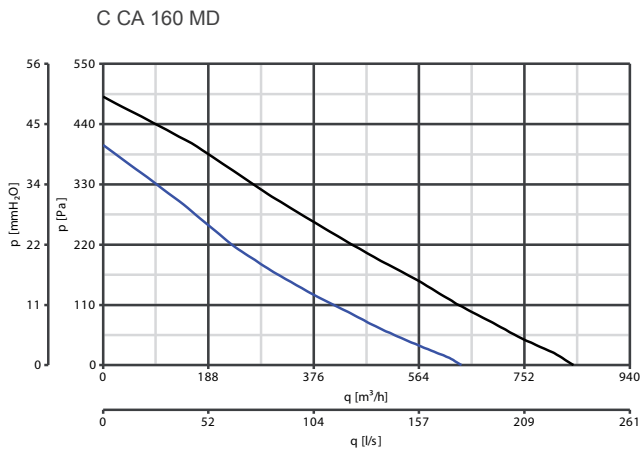
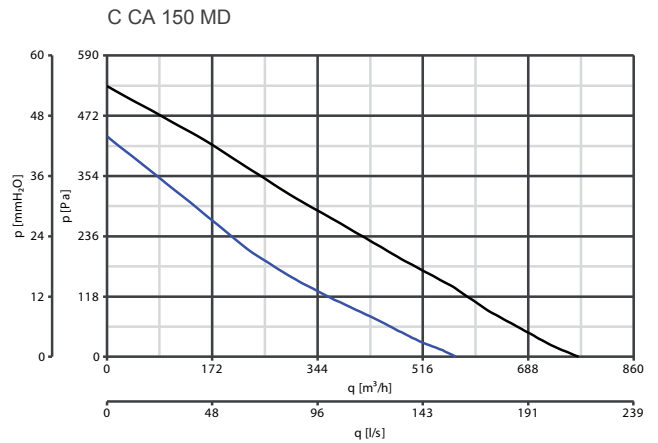
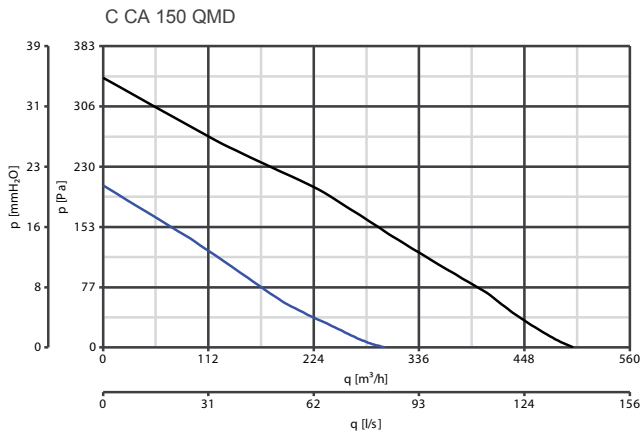
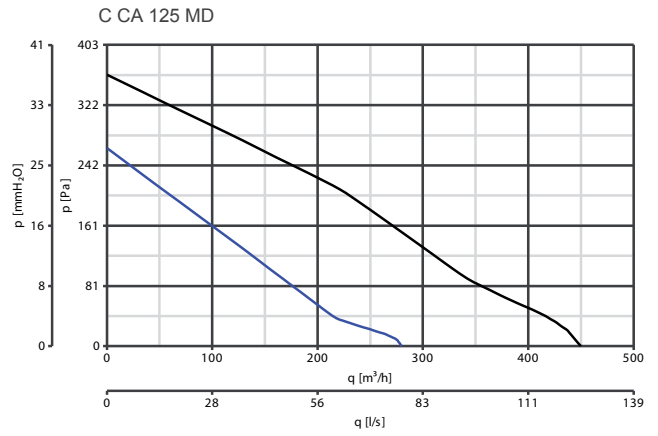
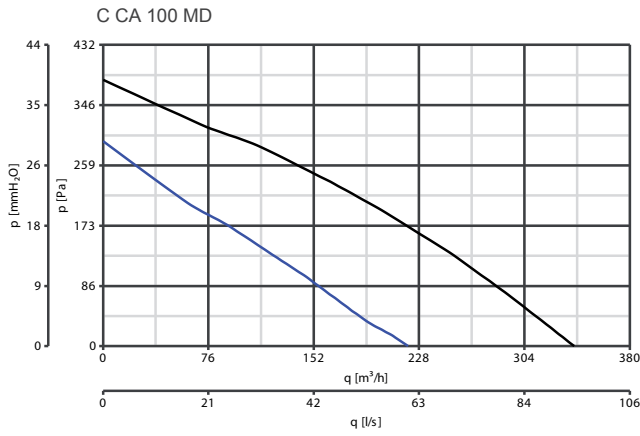

PERFORMANCE CURVES

