

V-RANGE

WALL / WINDOW & BUILT-IN
AXIAL EXTRACTOR FANS



VENTILATION
AIR CLEANING
HEATING



V-RANGE

For ventilation of medium or large rooms in homes or businesses.

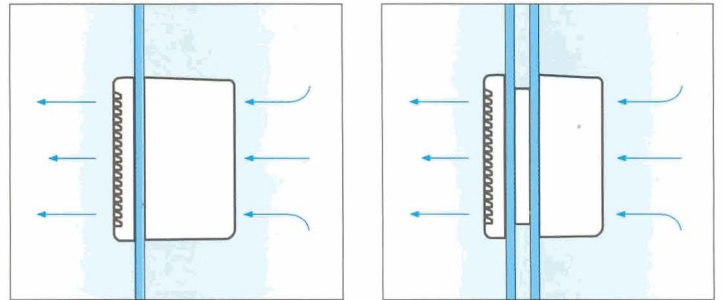







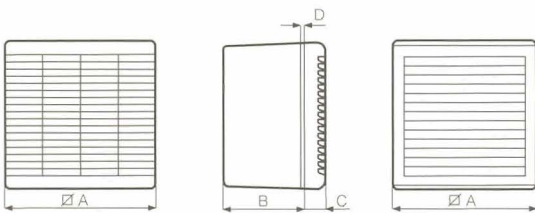





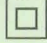

Axial window/wall surface mounted extractor fans with manual or automatic shutters

- Five manual, and reversible models in 15, 23 or 30 mm diameters.
- Integral time delay automatic shutter prevents back-draught when units is turned off.
- Motor with thermal overload.
- Fan with special blades for high performance and low noise level.
- IMQ Information label certifies product data and performance.
- Complies with the CEI 61-28 standards.
- ON light indicator (automatic models).
- External grille.
- Complete with fixing for double glazed installation.
- Max operating temperature: 50°C.

Design: F.Trabucco and M.Vecchi

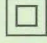

Vortice	∅ A	B	C	D	∅ hole dia.
15/6"	210	93	31	2+3	185+190
23/9"	291	128	31	2+3	257+262
30/12"	370	142	31	2+3	324+329

Product	Shutter	Code	V ~ 50 Hz	W	A	Rpm	m ³ /h	Lp dB(A) 3 m*	Approval	kg	Insulation
 Vortice 15/6" M	Manual	12780	220-240	30	0.16	1820	220	43		1.25	 cl.II
 Vortice 15/6" A	Automatic	12620	220-240	34	0.17	1820	220	43		1.4	 cl.II
 Vortice 23/9" M	Manual	12790	220-240	33	0.17	1260	620	43		3	 cl.II
 Vortice 23/9" AR	Automatic	12760	220-240	37	0.18	ext.1260 int.1340	ext.620 int.400	46		3.35	 cl.II
 Vortice 30/12" AR	Automatic	12770	220-240	74	0.35	ext.1080 int.1220	ext.1100 int.750	56		5.6	 cl.II

* Conforms with ISO 3744 for noise and pressure levels

V-RANGE built-in

For ventilation of medium or large rooms in homes or businesses.

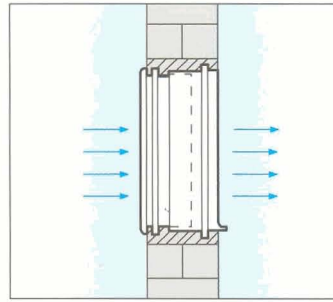

Wall-mounted axial extractor fans with automatic shutters

- Three automatic and reversible models in 15, 23 or 30mm diameters.
- Automatic shutter prevents back-draughts when the unit is turned off.
- Motor with thermal overload protection.
- Fan with special blades for high performance and low noise levels.
- IMQ information label certifies product data and performance.
- Complies with the CEI 61-28 standards.
- ON light indicator.
- External grille.
- Max operating temperature: 50°C
- Installation hole (wxh: 15/6" 290x325; 23/9" 360x370; 30/12" 440x480).

Design: F.Trabucco and M.Vecchi

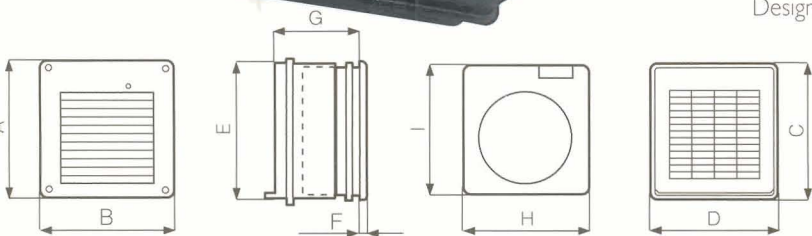

Vortice	A	B	C	D	E	F	G*	H	I
15/6" AI	306	290	317	276	282	13.5	141	283	299
23/9" ARI	370	355	365	344	345	13.5	178	356	364
30/12" ARI	467	432	473	431	423	13.5	190	422	456

* minimum values

Product	Code	V ~ 50 Hz	W	A	Rpm	m ³ /h	Lp dB(A) 3 m*	Approval	kg	Insulation
Vortice 15/6" AI	12730	220-240	34	0.17	1820	220	43		5	cl.II
Vortice 23/9" ARI	12750	220-240	37	0.18	exp. 1260 int. 1340	exp. 620 int. 400	50		5.4	cl.II
Vortice 30/12" ARI	12740	220-240	74	0.35	exp. 1080 int. 1220	exp. 1100 int. 750	56		7.5	cl.II

* Conforms with ISO 3744 for noise and pressure levels

Televortice

Infrared remote control for use with fans in this range (window or built in: V23/9 AR-ARI and V30/12 AR-ARI models only).

- Consists of a transmitter, receiver for switching on and off, changing speed and reversing, and transmitter box.
- Standby-status LED and function LED.
- Maximum operating distance up to 20 m in a straight line.

Design: F.Trabucco and M.Vecchi

Product	Code	Remote control	Receiver Volt at 50 Hz	Max low W	Trasmitter battery	Receiver kg	Trasmitter kg	Insulation
Televortice	22391	Infra-red	220-240	100	9V tipo PP3	0.66	0.06	cl.II



V-RANGE Accessoires

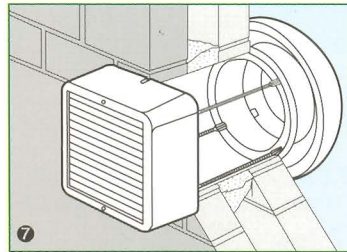
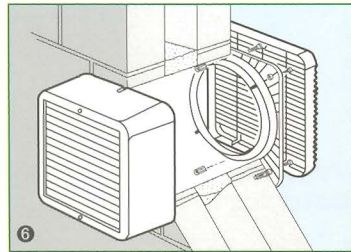
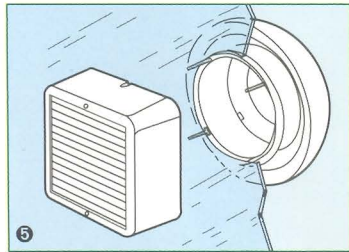
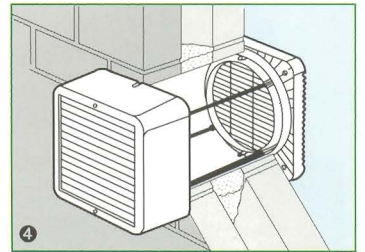
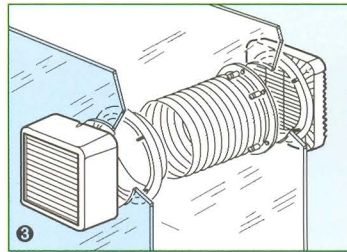
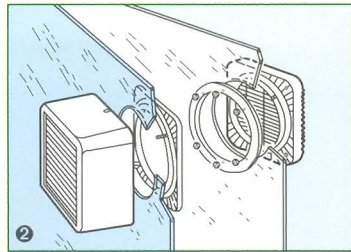
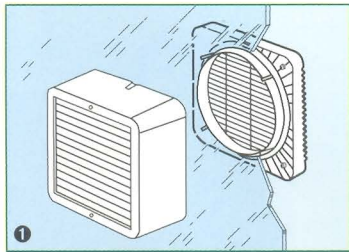

- 1 Single glazed mounting.
- 2 Double glazed opening secondary-glazed mounting.
- 3 Double window secondary-glazed mounting.
- 4 Wall-mounting with fixings.
- 5 Window-mounting with dark room.
- 6 Wall-mounting with expansion fixings.
- 7 Wall-mounting with dark room.

Humidity Control (code 12908)

Electronic thermo-humidistat (for V15/6" A, V23/9" AR and V23/9" AR models).



SCB5 Kit (code 22483)

For converting the speed controller from the external to the flush-mounted type.



Connectors and plastic duct for double window (code 13007-13010-13050)

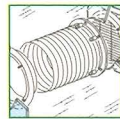

Flange for secondary glazing (which can be opened) (code 13006-13008-13051)

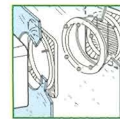

SCR5 (code 12930)

- Allows the extractor fan to be switched on and off, selecting the desired speed and reversing its operation.
- Kit SCB5 (code 22483) to convert to built-in.
- Weight: 0.58 kg.
- Max. load: 100W
- Double insulation.
- Gost approved.



Wall fixing kits (code 13060-13070)



Darkroom cowl (code 13009)



	Vortice 15/6" AI	Vortice 23/9" ARI	Vortice 30/12" ARI	Vortice 15/6" M	Vortice 15/6" A	Vortice 23/9" M	Vortice 23/9" AR	Vortice 30/12" AR
22391		•	•				•	•
12908	•	•	•		•		•	•
12930		•	•				•	•
22483		•	•				•	•
13008				•	•			
13006						•	•	
13051								•
13009						•	•	
13060				•	•			
13070						•	•	•
13010				•	•			
13007						•	•	
13050								•
13011				•	•	•	•	•

Cod. 5.170.084.805 - 10/2000 5289

Vortice Elettrosociali
Strada Cerca, 2
Frazione di Zoate
20067 Tribiano (Milano)
Tel. (+39) 02 906991
Fax (+39) 02 9064625
Italia

Vortice France
72, Rue Baratte-Cholet
94106 Saint Maur CEDEX
Tél. (+33) 1.55.12.50.00
Fax (+33) 1.55.12.50.01
France

Vortice Limited
Milley Lane - Hare Hatch
Reading - Berkshire -
RG10 9TH
Tel. (+44) 118-94.04.211
Fax (+44) 118-94.03.7878
United Kingdom



This publications cancels and supersedes all earlier ones.

<http://www.vortice.com>